

IEC Appliance Inlet C14, Screw-on Mounting, Front or Rear Side, Solder or Quick-connect Terminal



6100-3

C14



70 °C

**Description**

- Panel Mount:  
Screw-on from front or rear-side
- Appliance Inlet, Pin temperature 70 °C, Protection class I
- Solder terminals or quick connect terminals
- Alternative: protection class II version 6102-3

**Approvals**

- VDE License Number: 40015595
- UL License Number: E96454

**Other versions on request**

- Types for rivet mounting available upon request
- Sealing (IP54) of appliance and power input
- Types for enhanced glow wire test requirements acc. IEC 60695-2-11 to -13 for the use in unattended household equipment acc. IEC 60335-1

**References**

[General Product Information](#)

**Weblinks**

[Approvals](#), [RoHS](#), [CHINA-RoHS](#), [e-Store](#), [SCHURTER-Stock-Check](#), [Distributor-Stock-Check](#)

**Technical Data**

Ratings IEC	10 A / 250 VAC; 50 Hz
Ratings UL/CSA	15 A / 250 VAC; 60 Hz
Dielectric Strength	> 2 kVAC between L-N > 2 kVAC between L/N-PE (1 min/50 Hz)
Allowable Operation Temp.	-25 °C to 70 °C
Degree of Protection	from front side IP 40 acc. to IEC 60529
Protection Class	Suitable for appliances with protection class I acc. to IEC 61140
Terminal	Solder terminals or quick connect terminals
Panel Thickness s	Screw-on: max 8 mm Mounting screw torque max 0.5 Nm
Material: Housing	Thermoplastic, black, UL 94V-0

Appliance-Inlet/-Outlet	C14 acc. to IEC/EN 60320-1, UL 498, CSA C22.2 no. 42 (for cold conditions) pin-temperature 70 °C, 10 A, Protection class I
-------------------------	---

**Dimensions**

6100-3 (6102-3)

Length |—————| 48 mm

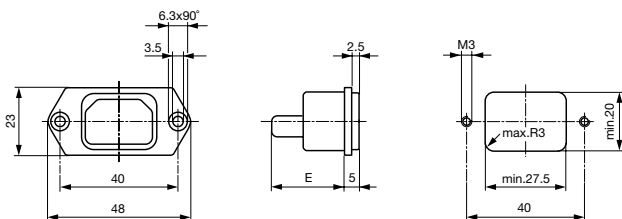

E: Solder terminals 20.5 mm

E: Quick connect terminals 23.5 mm

[Distributor-Stock-Check](#) | [SCHURTER-Stock-Check](#) | [e-Store](#)

## Variants

Type	Protection Class	Panel mounting	Panel Thickness s [mm]	Terminal	Order Number
6100-3	I	Screw-on	-	Quick connect terminals 4.8 x 0.8 mm	6100.3200
6100-3	I	Screw-on	-	Quick connect terminals 6.3 x 0.8 mm	6100.3300
6100-3	I	Screw-on	-	Solder terminals 3.5 x 0.8 mm	6100.3100

Option with IP54 sealing protects from entering fluids and dust into the appliance and the power input. This option can be ordered with ending ".30" (61xx.xxx.30).

The sealing to the appliance on its own (no protection of power input) is available as accessory (sealing kit).

Articles for enhanced glow wire test requirements acc. IEC 60695-2-11 to -13 can be ordered with ending ".15" (xxxx.xxx.15). They are suitable for the use in unattended household equipment acc. IEC 60335-1.

## Packaging unit

50 Pcs

## Accessory

## Description



**Sealing Kit**  
Sealing for Appliance Inlets

IP 54

0098.0103



**Assorted Covers**  
Rear Cover

0859.0048

4311.9401

4311.9402

4311.9404



**Cord retaining kits**  
Cord retaining strain relief

Flat head, A

4700.0001

## Mating Outlets/Connectors

## Category / Description

## Appliance Outlet



IEC Appliance Outlet F, Screw-on Mounting, Front Side, Solder or Quick-connect Terminal

4787

IEC Appliance Outlet F, Screw-on Mounting, Front Side, Solder or Quick-connect Terminal

4788

IEC Appliance Outlet F or H, Screw-on Mounting, Front Side, Solder, PCB or Quick-connect Terminal

5091

IEC Appliance Outlet F or H, Screw-on Mounting, Front Side, Solder or Quick-connect Terminal

5092



## Connector

IEC Connector C15, Rewireable, Straight	0101
IEC Connector C15A, Rewireable, Straight	0102
IEC Connector C15A, Rewireable, Straight	0102-G
IEC Connector C15A, Rewireable, Angled	0112
IEC Connector C13, Rewireable, Angled	4012
IEC Connector C13, Rewireable, Angled	4013
IEC Connector C13, Rewireable, Straight	4020
IEC Connector C13, Rewireable, Straight	4021
IEC Connector C13, Rewireable, Straight	4022
IEC Connector C13, Rewireable, Angled	4300-06
	...

## Power Cord



Power Cord with IEC Connector C13, Angled	0311
Power Cord with IEC Connector C13, Angled	3011
Power Cord with IEC Connector C13, Angled	3012
Power Cord with IEC Connector C13, Angled	3013
Power Cord with IEC Connector C13	3020
Power Cord with IEC Connector C13, Straight	3027
Power Cord with IEC Connector C13, Straight	302U
Power Cord with IEC Connector C13, Straight	3030
Power Cord with IEC Connector C13, Angled	311L
Power Cord with IEC Connector C13, Angled	312L
	...

## Power Supply or Interconnection Cord

Divers Power Supply and Interconnection Cords 10 A	Kabelverbindung/10 A
--	----------------------