

Fig. 1

- Series 3XX are available with straight and right angle solder tails.
- Series 350 & 399...009 use MM #3404 and #5011 pins. See pages 170 & 172 for details.
- Series 310 & 399...003 use MM #1001 and #1103 receptacles. See pages 134 & 135 for details.
- Receptacles use Hi-Rel, 4 finger #30 BeCu contact rated at 3 amps. See page 208 for details.
- Insulators are high temp. thermoplastic.



Ordering Information

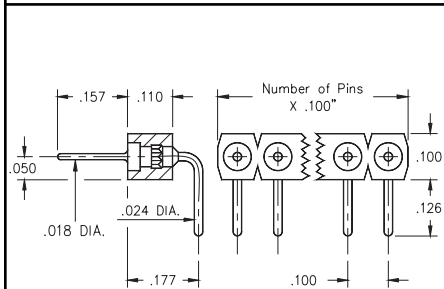

Fig. 2

Series 350...006 Straight Pin Header

Fig. 1

350-XX-1__-00-006000

Specify # of pins \rightarrow 01-64

Series 399...009 Right Angle Pin Header

Fig. 2

399-XX-1__-10-009000

Specify # of pins \rightarrow 01-64

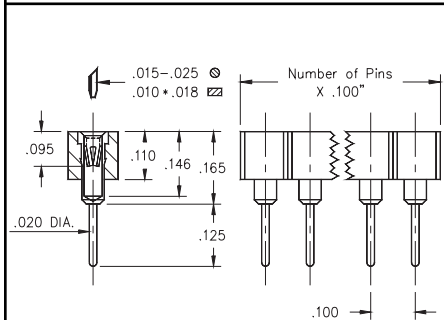

Fig. 3



XX= Plating Code
See Below

For RoHS compliance
select \diamond plating code.

SPECIFY PLATING CODE XX=	10 \diamond	90	40 \diamond	
Pin Plating	10 μ " Au	200 μ " Sn/Pb	200 μ " Sn	

Series 310...001 Straight Socket

Fig. 3

310-XX-1__-41-001000

Specify # of pins \rightarrow 01-64

Series 399...003 Right Angle Socket

Fig. 4

★ 41, 91 & 99 Platings Non-Standard

399-XX-1__-10-003000

Specify # of pins \rightarrow 01-64



XX= Plating Code
See Below

For RoHS compliance
select \diamond plating code.

SPECIFY PLATING CODE XX=	13 \diamond	91	93	99	41 \diamond	43 \diamond	44 \diamond
Sleeve (Pin)	10 μ " Au	200 μ " Sn/Pb	200 μ " Sn/Pb	200 μ " Sn/Pb	200 μ " Sn	200 μ " Sn	200 μ " Sn
Contact (Clip)	30 μ " Au	10 μ " Au	30 μ " Au	200 μ " Sn/Pb	10 μ " Au	30 μ " Au	200 μ " Sn